

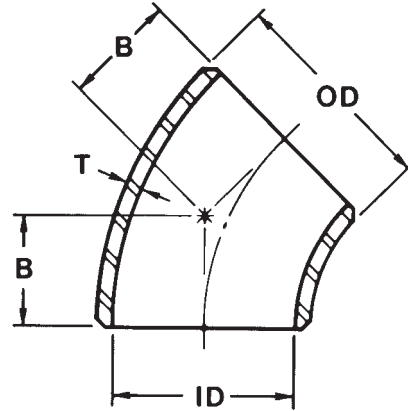

# 45° ELBOW — Long Radius



NOM PIPE SIZE	OUTSIDE DIAMETER (OD)	CENTER TO FACE (B)	SCHEDULE 10S Light N.P.S.			SCHEDULE 40S Standard N.P.S.		
			Wall Thickness (T)	Inside Diameter (ID)	Approx. Wt. in Pounds	Wall Thickness (T)	Inside Diameter (ID)	Approx. Wt in Pounds
1/2	.840	5/8	.083	.674	.04	.109	.622	.05
3/4	1.050	7/16	.083	.884	.04	.113	.824	.05
1	1.315	7/8	.109	1.097	.11	.133	1.049	.14
1-1/4	1.660	1	.109	1.442	.14	.140	1.380	.22
1-1/2	1.900	1-1/8	.109	1.682	.22	.145	1.610	.28
2	2.375	1-3/8	.109	2.157	.32	.154	2.067	.50
2-1/2	2.875	1-3/4	.120	2.635	.61	.203	2.469	.97
3	3.500	2	.120	3.260	.79	.216	3.068	1.36
3-1/2	4.000	2-1/4	.120	3.760	.95	.226	3.548	1.79
4	4.500	2-1/2	.120	4.260	1.36	.237	4.026	2.63
5	5.563	3-1/8	.134	5.295	2.29	.258	5.047	4.33
6	6.625	3-3/4	.134	6.357	3.43	.280	6.065	6.86
8	8.625	5	.148	8.329	6.75	.322	7.981	13.50
10	10.750	6-1/4	.165	10.420	12.50	.365	10.020	24.50
12	12.750	7-1/2	.180	12.390	17.00	.375	12.000	37.50
14	14.000	8-3/4	.188	13.624	23.00	.375	13.250	44.50
16	16.000	10	.188	15.624	30.00	.375	15.250	58.00
18	18.000	11-1/4	.188	17.624	38.00	.375	17.250	75.00
20	20.000	12-1/2	.218	19.564	63.00	.375	19.250	94.00
24	24.000	15	.250	23.500	89.00	.375	23.250	133.00

1. All dimensions are in inches
2. Dimensional tolerances conform to ASME B16.9
3. Fitting wall thicknesses conform with standard schedule 10S and 40S ASME B36.19M wall pipe.
4. Butt welding fittings are permanently marked by electro-chemical etching in accordance with ASME B16.9
5. Estimated fitting weights are based on a density of .163 lbs/cubic inch



# 90° ELBOW — Long Radius

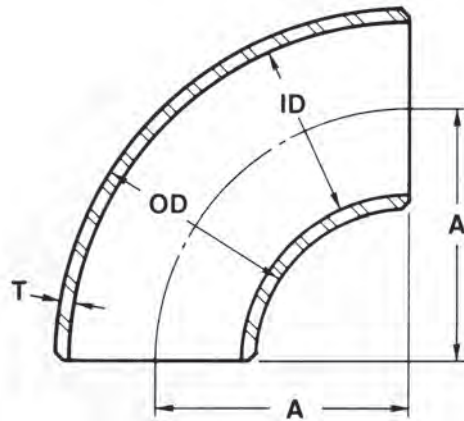

NOM PIPE SIZE	OUTSIDE DIAMETER (OD)	CENTER TO FACE (A)	SCHEDULE 10S Light N.P.S.			SCHEDULE 40S Standard N.P.S.		
			Inside Diameter (ID)	Wall Thickness (T)	Approx. Wt. in Pounds	Inside Diameter (ID)	Wall Thickness (T)	Approx. Wt in Pounds
1/2	.840	1-1/2	.674	.083	.08	.622	.109	.10
3/4	1.050	1-1/8	.884	.083	.09	.824	.113	.11
1	1.315	1-1/2	1.097	.109	.17	1.049	.133	.20
1-1/4	1.660	1-7/8	1.442	.109	.29	1.380	.140	.32
1-1/2	1.900	2-1/4	1.682	.109	.39	1.610	.145	.50
2	2.375	3	2.157	.109	.65	2.067	.154	.89
2-1/2	2.875	3-3/4	2.635	.120	1.08	2.469	.203	1.72
3	3.500	4-1/2	3.260	.120	1.54	3.068	.216	2.75
3-1/2	4.000	5-1/4	3.760	.120	2.14	3.548	.226	3.57
4	4.500	6	4.260	.120	2.72	4.026	.237	5.26
5	5.563	7-1/2	5.295	.134	4.58	5.047	.258	8.65
6	6.625	9	6.357	.134	6.86	6.065	.280	13.75
8	8.625	12	8.329	.148	13.50	7.981	.322	27.00
10	10.750	15	10.420	.165	25.00	10.020	.365	48.50
12	12.750	18	12.390	.180	34.00	12.000	.375	75.00
14	14.000	21	13.624	.188	46.00	13.250	.375	89.00
16	16.000	24	15.624	.188	60.00	15.250	.375	116.00
18	18.000	27	17.624	.188	75.00	17.250	.375	154.00
20	20.000	30	19.564	.218	126.00	19.250	.375	189.00
24	24.000	36	23.500	.250	177.00	23.250	.375	265.00

1. All dimensions are in inches
2. Dimensional tolerances conform to ASME B16.9
3. Fitting wall thicknesses conform with standard schedule 10S and 40S ASME B36.19M wall pipe.
4. Butt welding fittings are permanently marked by electro-chemical etching in accordance with ASME B16.9
5. Estimated fitting weights are based on a density of .163 lbs/cubic inch